

# BEACH HOUSE SERIES | ○ ○



 100m<sup>2</sup>  
Living Area

 14m<sup>2</sup>  
Deck Area

 12.0m  
Total Length

 11.28m  
Total Width

**DIT KIT PRICE**  
**\$78,980**

**STEEL FLOOR**  
**\$23,055**

**INTERNAL LINING**  
**\$23,785**



3 Bedrooms



2 Bathrooms



1 Living Area

# BEACH HOUSE SERIES

## DIY Kit Inclusions

- Pre-Assembled Steel Frames & Trusses
- Sliding Windows & Doors as per the Plan
- CGI Roof Sheets, Metal Gutter, Fascia & Flashing
- Horizontal CGI Wall Sheets & Trims
- N2 Wind Rating
- Fastener Kit
- 2.7mH Ceilings/Raked as per Plan
- Deck Roof as Pictured
- Steel Roof & Ceiling Battens

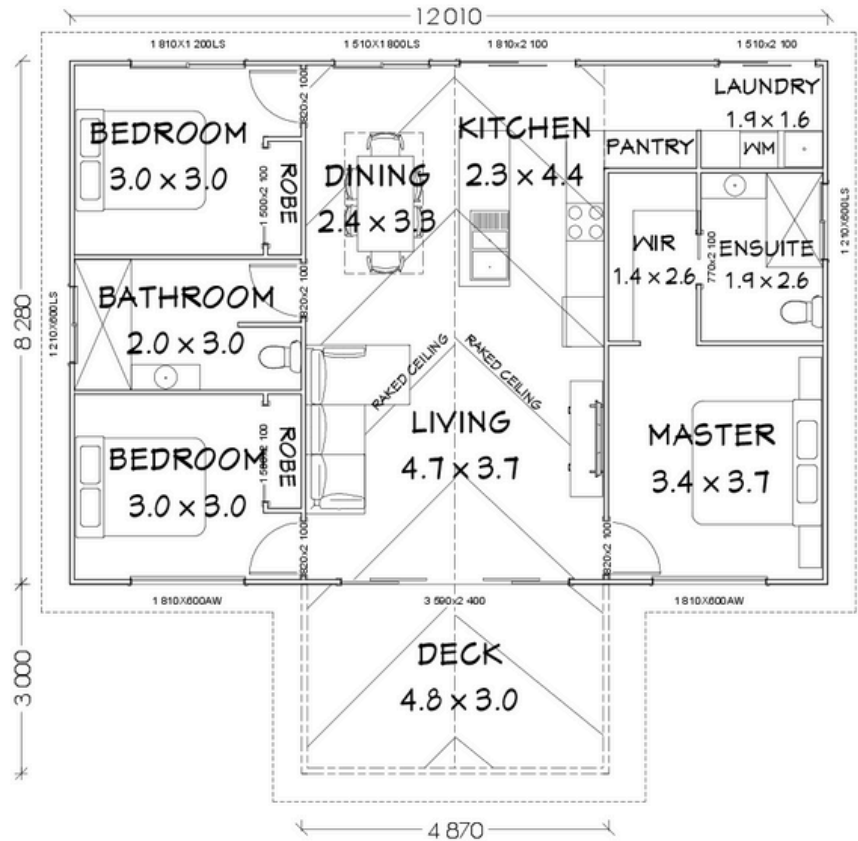

## Steel Floor Inclusions

- Steel Bearers & Joists for Building & Deck
- Yellow Tongue Flooring Throughout
- FC Tile Underlay for Wet Areas

## Internal Lining Kit Inclusions

- Plasterboard inc Consumables & Cornice
- Skirting & Architraves
- Internal Hinged & Cavity Doors
- Thermal Break
- External Wall Batts
- Roof Blanket

Thermal Break & Roof Blanket available for an additional \$5,735.

HardiePlank 230mmW FC Weatherboard is available for an additional \$1,890.

All prices are valid for kits supplied within SE QLD. Additional charges will apply outside of this area.