

# THE COASTAL

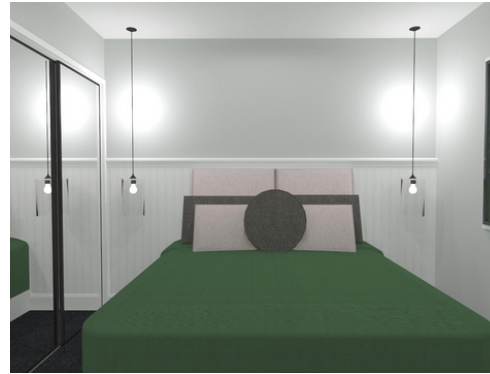

49m<sup>2</sup>  
LIVING AREA

17.5m<sup>2</sup>  
DECK AREA

2  1  1 

## DIY KIT PRICE - \$33,660\*

+Pre Assembled Steel Wall Frames & Roof Trusses

- +Roof & Ceiling Battens
- +450mm Eaves
- +2.55mH Ceilings
- +Sliding Windows & Doors
- +CGI Roof Sheets, Fascia & Gutters
- +Horizontal CGI Wall Sheets & Trims
- +Deck Roof, Posts & Beams
- +N2 Wind Rating
- +Fastener Kit

## STEEL FLOOR SYSTEM - \$11,935

- +Steel C-Purlin Bearers (incl. Deck)
- +Steel C-Purlin Joists (incl. Deck)
- +Yellow Tongue Flooring Throughout
- +FC Tile Underlay for Bathroom

## INTERNAL LINING KIT - \$14,875

- +Plasterboard incl. all plaster products
- +Skirting & Architraves
- +90mm Cove Cornice
- +Internal Doors (excl. robes)
- +Thermal Break
- +External Wall Insulation
- +Roof Blanket

### OPTIONAL EXTRAS

HardiePlank 230mmW FC Weatherboard in smooth or woodgrain finish is available for an additional \$885.

Engineering Certificate (Form 15) is available for an additional charge.

Thermal Break & Roof Blanket available for an additional \$2,835.

\*Bluescope ColorBond CGI Roof & Wall Sheets are available for an additional \$2,400. Applies to all kits supplied outside of SE QLD.

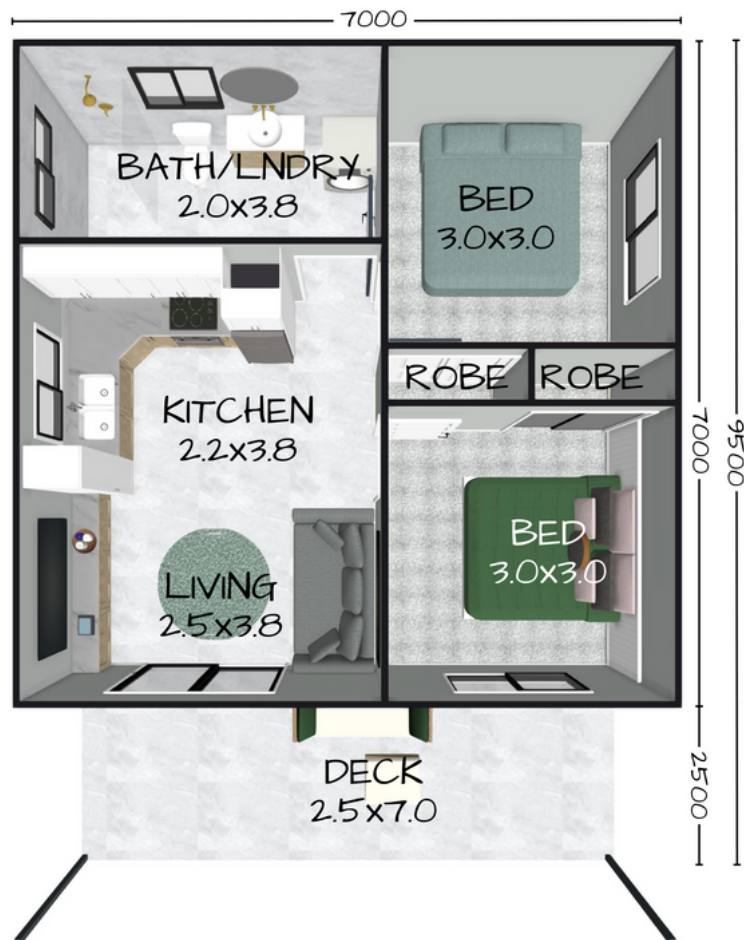

# THE COASTAL

