

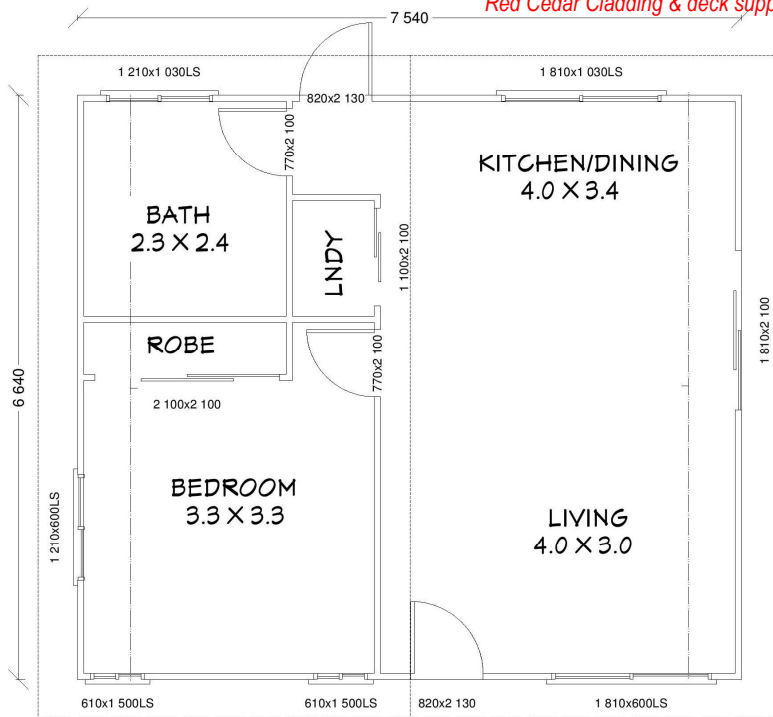

*Red Cedar Cladding & deck supplied by client. Not included in pricing*



## DIY Kit Price – SE QLD\*

For your Slab | \$18,545  
On Full Galv. Chassis | \$24,800

### For your Concrete Slab Kit Inclusions

- Pre Assembled Steel Wall Frames
- Pre Assembled Steel Trusses
- Ceiling Battens
- Roof Battens
- Fastener Kit
- 450mm Eaves
- 2.55m High Ceilings
- N2 Wind Rating
- Sliding Glass Windows
- Sliding Glass Door
- CGI Roof Sheets
- 1'Choice of Cladding
- Gutters, Fascia & Eave Lining
- Trims

### On Full Galvanised Chassis Kit Inclusions

- Pre Assembled Steel Wall Frames
- Pre Assembled Steel Trusses
- Ceiling Battens
- Roof Battens
- Fastener Kit
- 450mm Eaves
- 2.55m High Ceilings
- N2 Wind Rating
- Sliding Glass Windows
- Sliding Glass Door
- CGI Roof Sheets
- 1'Choice of Cladding
- Gutters, Fascia & Eave Lining
- Trims
- Yellow Tongue Flooring
- FC Tile Underlay for Bathroom
- Full C-Purlin Galvanised Chassis

### \*Cladding options included:

- Horizontal Corrugated Iron Wall Sheets
- PRIMApLank™ 230mm Wide Smooth or Woodgrain Finish Weatherboard (additional \$500)

\*Bluescope CGI Roof and Wall Sheets available for additional \$1,000. Applies to all purchases outside of SE QLD.